

Part Installation Instruction

Main Board Kit

June 2015

WD21X21916

Introduction: A CSM (Current Sense Module) is built into this new main control board, all parts of this control board kit **MUST** be used.

Parts Included: Control Board, Bottom Cover, Power Supply Harness, Insulation Shield, Board Standoffs, Ground Screw

- Step 1 – Place the new insulator onto the new control box bottom cover
- Step 2 – Install the new standoffs (4) onto the new bottom cover as shown below
- Step 3 – Push the new control onto the standoffs
- Step 4 – Ground Screw on control **MUST** be installed
- Step 5 – Set personality as instructed in separate control instructions

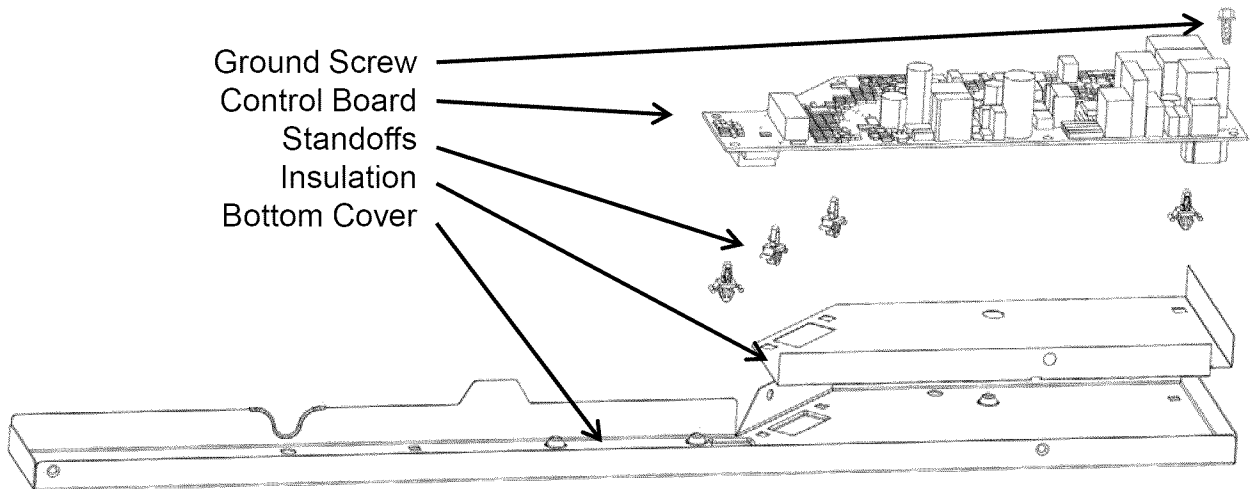

- Step 6 – Install bottom cover and board into the dishwasher
- Step 7 – Install new Power Supply Harness using the old ground screws on the junction box bracket, new ground wires **MUST** be installed in separate mounting holes.
- Step 8 – Re-install junction box cover to avoid risk of fire or personal injury.
- Step 9 – Test operation

