

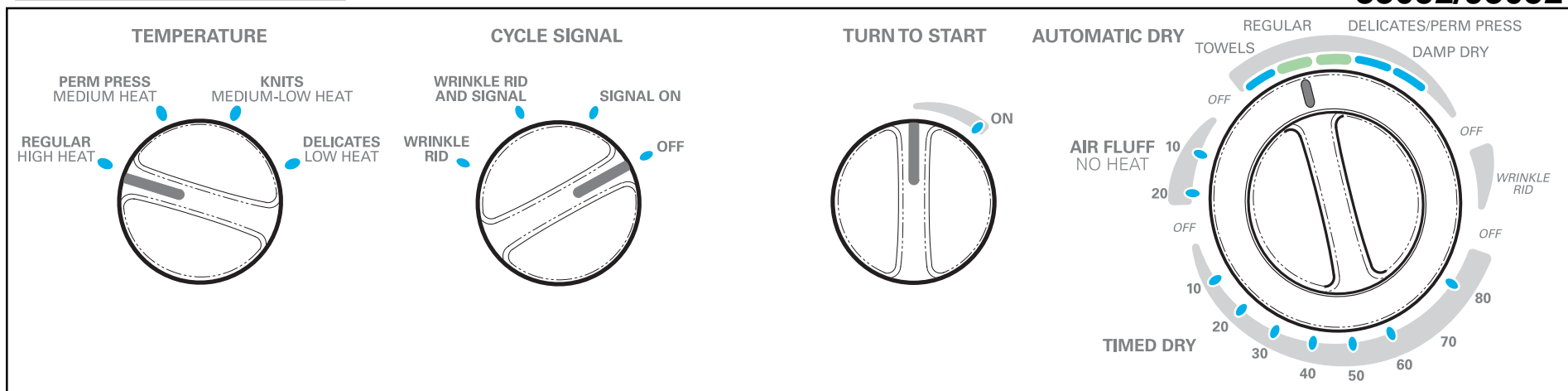

# OPERATING INSTRUCTIONS

83042/93042  
83052/93052



## Before Operating Your Dryer

Read your dryer Use and Care Guide. It has important safety and warranty information. It also has many suggestions for best drying results.

**⚠ WARNING** To reduce the risk of fire, electric shock, or injury to persons, read the IMPORTANT SAFETY INSTRUCTIONS in your dryer Use and Care Guide before operating this appliance.

## Operating Steps

Read **Drying Procedures** in your Use and Care Guide. It explains these operating steps in detail.

1. Prepare items for drying.
2. Check that lint screen is clean and in place.
3. Load the dryer. If desired, add a dryer fabric softener sheet.
4. Close the dryer door.
5. Set Temperature and Wrinkle-Rid/Signal controls as desired.

Printed in U.S.A.

6. Turn cycle selector clockwise to desired setting.

7. **Start dryer.** Turn the Turn to Start control clockwise to ON. Hold for 1-2 seconds and release.

8. When Signal Option control is on, a signal will sound near the end of the cycle. When Wrinkle-Rid/Signal option is selected, a signal will sound every 5 minutes as a reminder to remove the load during WRINKLE RID.

9. Remove items immediately and hang or fold.

10. Clean lint screen after every load.

## Temperature Selection

Always follow directions on fabric care labels.

**⚠ WARNING** To avoid fire hazard, do not use heat to dry items containing feathers or down, foam rubber, plastics, or similarly textured, rubber-like materials. Use the Air Fluff-No Heat cycle only.

Select the temperature most suitable for each load. The REGULAR-HIGH HEAT, PERM PRESS-MEDIUM HEAT, KNITS-MEDIUM-LOW HEAT, and DELICATES-LOW HEAT temperature settings may be used with any cycle setting.

## Cycle Selection

Turn cycle selector clockwise to desired cycle and setting.

The Automatic Dry and Timed Dry cycles end with a cool down period. The heat automatically turns off and the load continues to tumble during the cool down period. This reduces wrinkling and makes items easier to handle during unloading.

Drying time varies depending on size and dampness of load, weight and fabric type. Room temperature and humidity, type of installation and electrical voltage or gas pressure can also affect drying time.

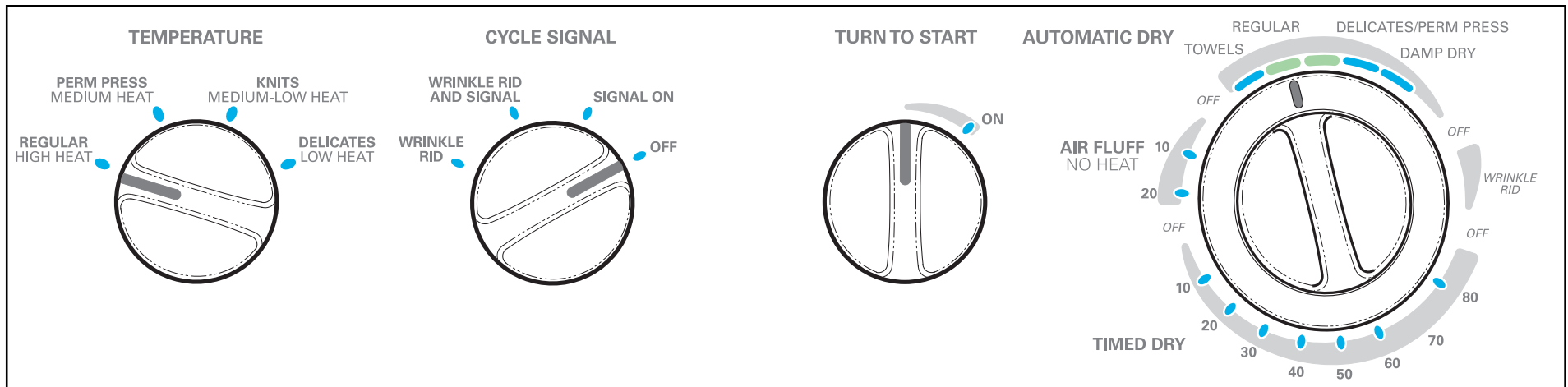

## Cycle Selection (continued)

### Automatic Dry Cycle

- **TOWELS** - This setting is best for towel loads. Select the REGULAR--HIGH HEAT temperature setting.
- **REGULAR** - This setting is best for cotton items. Select the REGULAR--HIGH HEAT temperature setting.
- **DELICATES/PERM PRESS** - This setting is best for delicate, knit, or perm press items. Select the PERM PRESS--MEDIUM HEAT temperature setting for permanent press items, the KNITS -- MEDIUM/LOW HEAT temperature setting for most knit items, or the DELICATES--LOW HEAT temperature setting for delicate items.
- Occasionally a load may seem too damp or overdried at the end of the cycle. To increase drying time for similar loads in the future, set the cycle selector to the left of the TOWELS, REGULAR, or DELICATES/PERM PRESS. For loads requiring less drying time, set the cycle selector to the right.

- **DAMP DRY** - This setting is best for items you wish to partially dry before hanging or ironing. Select the temperature setting most suitable for the load.

- **WRINKLE-RID** - If the dried load cannot be removed promptly at the end of the cycle, the cycle selector will **automatically** advance to the WRINKLE RID setting if the **WRINKLE RID** option is turned **ON**. Unheated tumbling continues for up to 24 minutes to help reduce wrinkling. The timer **will not** automatically advance into the WRINKLE RID setting if the **WRINKLE RID** option is turned **OFF**.

**Note:** WRINKLE RID can be used independently for up to 15 minutes of unheated tumbling to help remove wrinkles from items that are already dry. Turn selector knob to WRINKLE RID and start dryer. It is not necessary to set Temperatures or WRINKLE RID option controls.

### Air Fluff Cycle

This cycle provides up to 20 minutes of tumbling without heat. Use AIR FLUFF to dry items containing feathers or down, foam rubber, plastics, or similarly textured, rubber-like materials, to freshen clothing, pillows or blankets, or to dust draperies.

### Timed Dry Cycle

This cycle provides up to 80 minutes of drying time at the temperature selection of your choice.

### Energy Saving Tips

- Keep the lint screen clean and exhaust the dryer correctly.
- Sort laundry properly and select proper temperature and cycle settings. Choose the Automatic cycle whenever possible for accurate drying time.
- Dry only full loads. Single items and small loads usually take longer to dry.
- Avoid overloading, adding wet items to a partially dry load, and overdrying.
- Dry one load after another to take advantage of a warm dryer.
- Opening the door needlessly causes warm air to escape, which prolongs drying time.
- If possible, use the dryer on low humidity days.
- Install the dryer in an area where the room temperature is at least 45°F (7°C).