



# Use & Care

G U I D E

## EASY CLEAN 100™ Electric and Gas Dryers

A Note to You .....	2
Dryer Safety .....	3-4
Parts and Features ...	5
Checking Your Vent ...	6
Operating Your Dryer .....	8
Caring for Your Dryer .....	14
Troubleshooting .....	20
Requesting Assistance or Service .....	22
Index .....	23
Warranty .....	24

**1-800-253-1301**

Call us with questions or comments.



Making Your World  
A Little Easier.™

# A NOTE TO YOU

## Thank you for buying a WHIRLPOOL® appliance.

Because your life is getting busier and more complicated, WHIRLPOOL dryers are easy to use, save time, and help you manage your home better. To ensure that you enjoy years of trouble-free operation, we developed this Use and Care Guide. It is full of valuable information about how to operate and maintain your appliance properly and safely. Please read it carefully.

Also, complete and mail the **Ownership Registration Card** provided with your appliance. The card helps us notify you about any new information on your appliance.

## Please record your model's information.

Whenever you call to request service for your appliance, you need to know your complete model number and serial number. You can find this information on the model and serial number label (see the diagram in the "Parts and Features" section for the location of the label). Also, record the other information shown in the next column.

**Model Number** \_\_\_\_\_

**Serial Number** \_\_\_\_\_

**Purchase Date** \_\_\_\_\_

**Dealer Name** \_\_\_\_\_

**Dealer Address** \_\_\_\_\_

**Dealer Phone** \_\_\_\_\_

## Keep this book and the sales slip together in a safe place for future reference.

**Our Consumer Assistance Center number is toll-free.**

**1-800-253-1301**

# DRYER SAFETY

## Your safety is important to us.

This guide contains safety symbols and statements. Please pay special attention to these symbols and follow any instructions given. Here is a brief explanation of the use of the symbol.



This symbol alerts you to hazards such as fire, electrical shock, or other injuries.

**WARNING:** For your safety, the information in this manual must be followed to minimize the risk of fire or explosion, or to prevent property damage, personal injury, or loss of life.

- Do not store or use gasoline or other flammable vapors and liquids in the vicinity of this or any other appliance.
- **WHAT TO DO IF YOU SMELL GAS:**
  - Do not try to light any appliance.
  - Do not touch any electrical switch; do not use any phone in your building.
  - Clear the room, building, or area of all occupants.
  - Immediately call your gas supplier from a neighbor's phone.  
Follow the gas supplier's instructions.
  - If you cannot reach your gas supplier, call the fire department.
- Installation and service must be performed by a qualified installer, service agency, or the gas supplier.

continued on next page

## IMPORTANT SAFETY INSTRUCTIONS

**WARNING** – To reduce the risk of fire, electric shock, or injury to persons when using the dryer, follow basic precautions, including the following:

- Read all instructions before using the dryer.
- Do not dry articles that have been previously cleaned in, washed in, soaked in, or spotted with gasoline, dry-cleaning solvents, other flammable, or explosive substances as they give off vapors that could ignite or explode.
- Do not allow children to play on or in the dryer. Close supervision of children is necessary when the dryer is used near children.
- Before the dryer is removed from service or discarded, remove the door to the drying compartment.
- Do not reach into the dryer if the drum is moving.
- Do not install or store the dryer where it will be exposed to the weather.
- Do not tamper with controls.
- Do not repair or replace any part of the dryer or attempt any servicing unless specifically recommended in this Use and Care Guide or in published user-repair instructions that you understand and have the skills to carry out.
- Do not use fabric softeners or products to eliminate static unless recommended by the manufacturer of the fabric softener or product.
- Do not use heat to dry articles containing foam rubber or similarly textured rubber-like materials.
- Clean lint collector basket when indicator window shows basket is full.
- Keep area around the exhaust opening and adjacent surrounding areas free from the accumulation of lint, dust, and dirt.
- The interior of the dryer and exhaust vent should be cleaned periodically by qualified service personnel.
- See Installation Instructions for grounding requirements.

– SAVE THESE INSTRUCTIONS –

# PARTS AND FEATURES

The parts and features of your dryer are illustrated on this page. Become familiar with all parts and features before using your dryer. Page references are included next to some features. Refer to those pages for more information about the features.

**NOTE:** The drawings in this book may vary from your dryer model. They are designed to show the different features of all models covered by this book. Your model may not include all features.

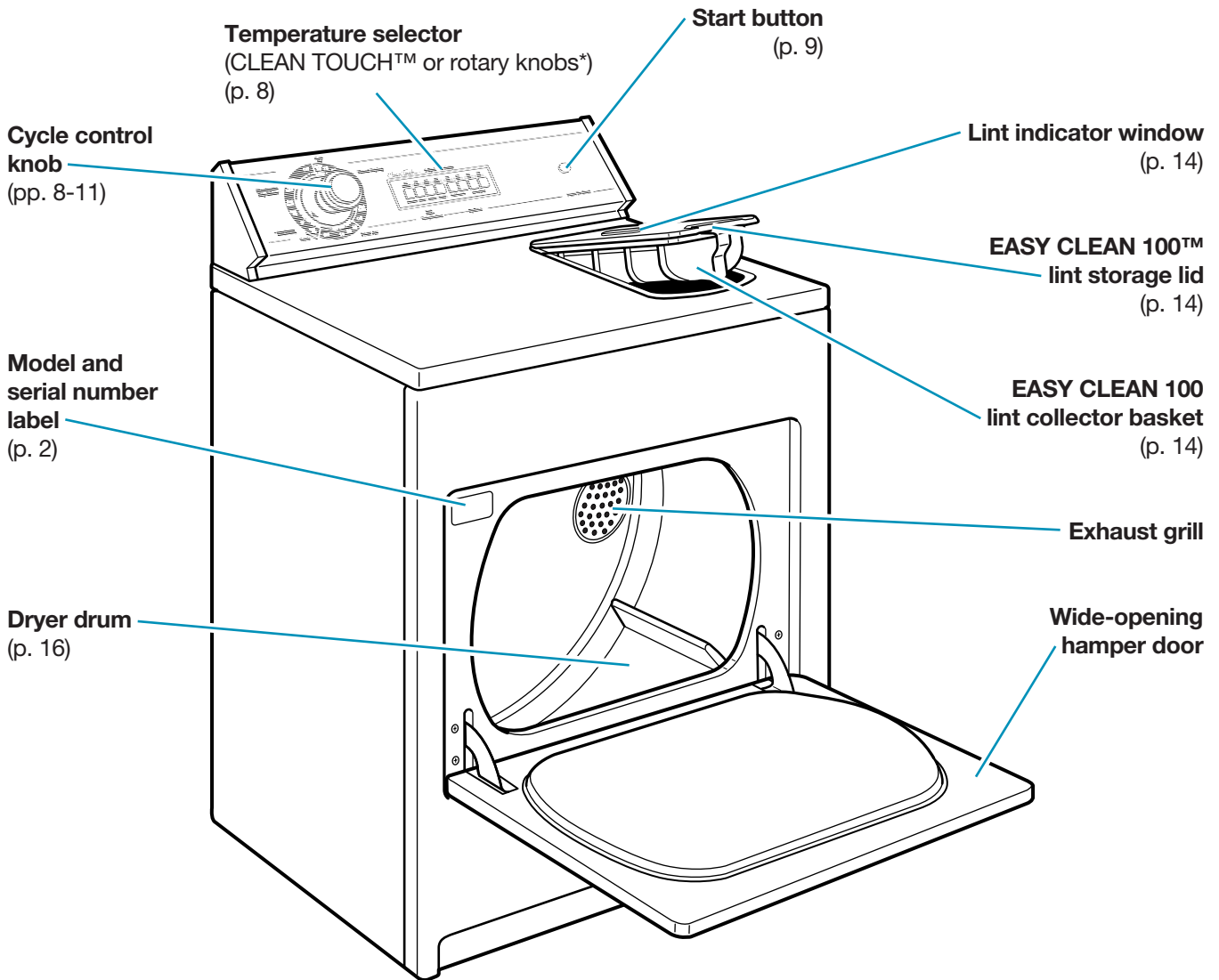

## Additional features your dryer may have:

- End of cycle signal selector (p. 8)
- FINISH GUARD® feature selector (p. 8)
- Drying rack (p. 13)
- Drum light (p. 17)

\* On some models

# CHECKING YOUR VENT

Your dryer must be properly installed and vented to achieve maximum drying efficiency and shorten drying times. Install your dryer in a well-ventilated room where the temperature is always above 45°F (7°C). Also make sure that your dryer is leveled. Refer to your Installation Instructions for more information.

## VENTING

**⚠ WARNING**



**Fire Hazard**

- Use a heavy metal vent.
- Do not use a plastic vent.
- Do not use a metal foil vent.
- Failure to follow these instructions can result in death or fire.

If the dryer is not properly installed and vented, it will not be covered under the warranty.

**NOTE:** Service calls caused by improper venting will be paid for by the customer, whether it was a paid installation or self-installed. For paid installation, call the company that installed the vent for adjustment.

**1.** Four-inch heavy metal or flexible metal vent must

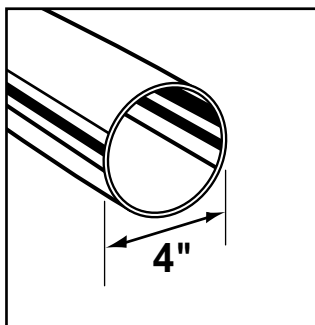

length requirements of vent.

be used. **Do not** use plastic vent or flexible metal foil vent. Do not kink or crush flexible metal vent. It must be completely extended to allow adequate exhaust air to flow. Check vent after installation. Refer to your Installation Instructions for proper

**2.** Use a 4" exhaust hood. Smaller hoods increase drying times.

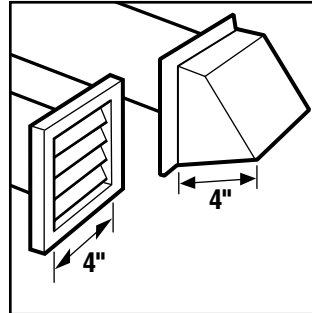

**3.** The exhaust vent can be routed up, down, left, right, or straight out the back of the dryer. Space requirements are listed in your Installation Instructions.

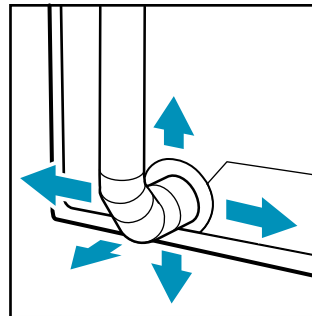

## VENTING (CONT.)

- 4.** Use the straightest path possible when routing the exhaust vent. Avoid 90° turns, if possible. Allow room when using elbows or making turns. Bend vent gradually to avoid kinking.

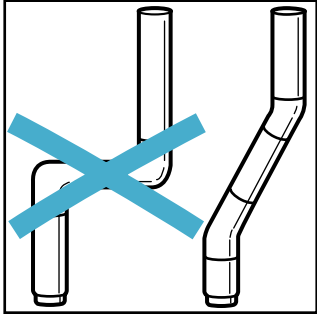

- 5.** Use duct tape to seal all joints. **Do not** use screws to secure vent. Lint may catch on screws.

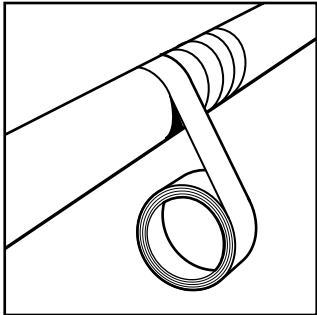

- 6.** Clean exhaust vent periodically, depending on use, but at least every 2 years, or when installing your dryer in a new location.

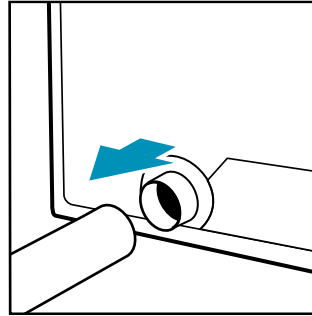

● Disconnect vent from the dryer and clean one section at a time until you reach the exhaust hood.

● Use the hose attachment on your vacuum, or a pole or wire with a

feather duster or rag attached, to clean out lint.

- Be sure the flapper on the outside end of vent moves freely.
- When cleaning is complete, be sure to follow the Installation Instructions supplied with your dryer for final product check.

# OPERATING YOUR DRYER

To get the best dryer results possible, you must use your dryer correctly. This section tells you how to use your dryer properly and efficiently.

## STARTING YOUR DRYER

### ⚠ WARNING



#### Explosion Hazard

Never place items in the dryer that are dampened with gasoline or other flammable fluids.

No washer can completely remove oil.

Do not dry anything that has ever had any type of oil on it (including cooking oils).

Doing so can result in death, explosion, or fire.

Before using your dryer, wipe the dryer drum with a damp cloth to remove dust from storing and shipping. If your dryer has a Features Guide, remove it and place it with this Use and Care Guide.

1. Load clothes loosely into the dryer and close the door. Do not pack the dryer; allow space for clothes to tumble freely.



2. Make sure the lint collector basket lid is securely closed, and that the lint indicator window is not full. (See the “Using and maintaining the EASY CLEAN 100™ lint feature” section.)

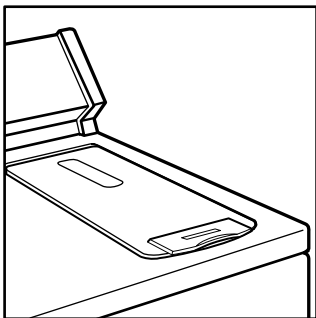

3. Turn the Cycle Control Knob to the recommended cycle for the type of load being dried, as described in the “Cycle descriptions” section.

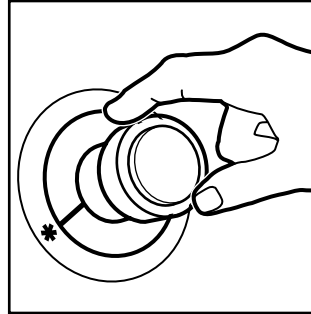

- Use the Energy Preferred Automatic Setting (\*) to dry most loads.

4. Set the Temperature selector to the recommended setting for the type of fabric being dried. The cycle descriptions on the following pages include temperature setting suggestions.

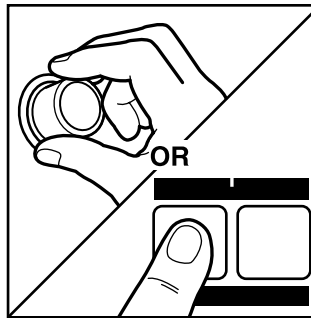

5. (OPTIONAL STEP) Some dryers have an On/Off FINISH GUARD® selector. The FINISH GUARD feature protects your clothes from wrinkling when you do not remove them from the dryer as soon as it stops.

- Set the FINISH GUARD selector to On to tumble the load without heat every few minutes up to 45 minutes after the drying cycle ends.
- A signal will sound every few minutes while FINISH GUARD is running if the Cycle Signal (End of Cycle Signal) feature is set to On. On some models, this signal is fixed and cannot be turned off. The signal and cycle end when you open the dryer door.
- Set the FINISH GUARD selector to Off if you do not want to run this feature.

**NOTE:** Some dryers have a fixed FINISH GUARD feature that cannot be turned off.



## STARTING YOUR DRYER (CONT.)

6. (OPTIONAL STEP) Set the End of Cycle Signal selector to On if you want your dryer to sound a signal when a cycle is finished.
- The signal is helpful when you are drying permanent press, synthetics, and other items that should be removed from the dryer as soon as it stops.
  - On some models, the End of Cycle Signal is part of the Start Button.
7. Push the Start Button.

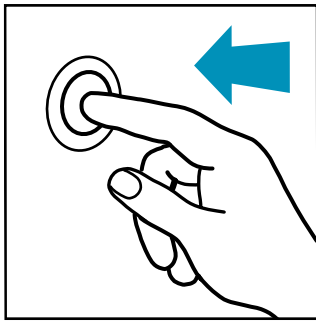

**NOTE:** Your dryer stops automatically when a cycle ends.

### Stopping and restarting your dryer

You can stop your dryer anytime during a cycle.

#### To stop your dryer:

Open the dryer door or turn the Cycle Control Knob to Off.

**NOTE:** The Cycle Control Knob should point to an Off area when the dryer is not in use.

#### To restart your dryer:

Close the door, select a new cycle and temperature (if desired), and push the Start Button.

## SELECTING THE RIGHT CYCLE AND TEMPERATURE SETTING

The following pages describe the drying cycles on your dryer. The descriptions include suggested temperature settings and drying times for various loads.

### Cycle and temperature tips

- Make sure you have selected the correct cycle and temperature for your load.
- Dry most loads using the Energy Preferred Automatic Setting (\*).
- Use the Fluff Air cycle, or line dry rubber, plastic, delicate, and heat-sensitive fabrics.
- If some types of loads in the cycle descriptions on the following pages have more than one suggested temperature setting, choose the lowest setting available on your dryer.
- The last few minutes of all cycles are without heat to make the load cooler to handle.

### Drying tips

- Always follow care label directions when they are available.
- If you use fabric softener sheets, always use softener sheets that are labeled as dryer safe and follow package instructions carefully.
- Remove the load from the dryer as soon as tumbling stops to reduce wrinkling. This is especially important for permanent press, knits, and synthetic fabrics.
- Check the EASY CLEAN 100™ lint indicator window. If full, refer to the “Using and maintaining the EASY CLEAN 100 lint feature” section.

# CYCLE DESCRIPTIONS

## Automatic cycle(s)

Use an Automatic cycle to dry most loads.

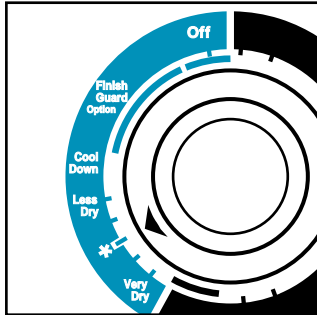

Depending on your model, the Automatic cycle uses either an electronic or automatic DRY-MISER® control that senses the moisture in the load and shuts off the dryer when the selected dryness is reached.

The Cycle Control Knob

does not move until the load is almost dry. After the cool-down, the Knob automatically turns to an Off area and tumbling stops.

- If the load is drier than you like, select a setting closer to **Less Dry** the next time you dry a similar load.
- If the load is not as dry as you like, complete drying using a Timed cycle. Select a setting closer to **Very Dry** the next time you dry a similar load.

Drying time with an Automatic cycle varies according to the type of fabric, size of load, and dryness setting. Your model may not have all heat settings listed. Some general guidelines are:

- Use a high heat setting for drying heavyweight items, such as towels and work clothes.
- Use a medium heat setting for drying medium-weight items, such as sheets, underwear, permanent press clothes, and some knits.
- Use a low heat setting for drying lightweight items such as lingerie, blouses, dresses, and some knits.

**NOTE:** If you have any questions about drying temperatures for various loads, refer to care label directions.

## Timed cycle(s)

Use a Timed drying cycle to complete drying if some items are damp after the Automatic cycle. A Timed drying cycle is also useful for:

- Heavyweight and bulky items, such as bedspreads and work clothes, and large loads that require a long drying time. Set your dryer for High heat.
- Lightweight items, such as lingerie, blouses, and knits that require a short drying time. Set your dryer for Low heat.
- Drying time and temperature will depend on your dryer model.

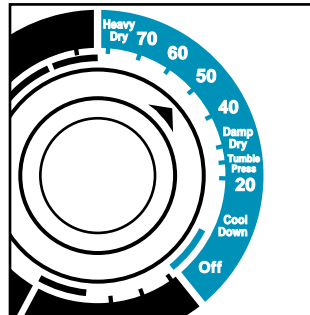

## Fluff Air cycle

Use the unheated Fluff Air cycle for items that require drying without heat. See the chart in the “Fluff air cycle” section for examples of items that require air drying.

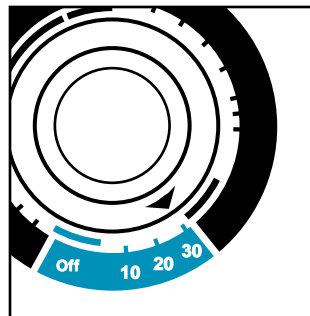

## Heavy Dry cycle (on some models)

Use the Heavy Dry cycle to dry large items or items that are thicker or heavier than a regular load (such as heavy cotton bath towels or robes.) Set your Cycle Control Knob to Heavy Dry and your Temperature selector to High heat.

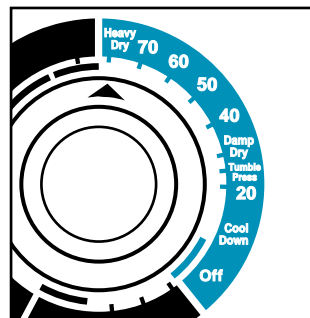

## CYCLE DESCRIPTIONS (CONT.)

### Damp Dry feature

Use the Damp Dry feature in the Timed cycle to dry items to damp level or to dry items that do not require an entire drying cycle. Two examples are heavy cottons, such as jeans, which you do not want to become stiff, or cotton clothes which are easier to press when damp. Set the Temperature selector to High heat.

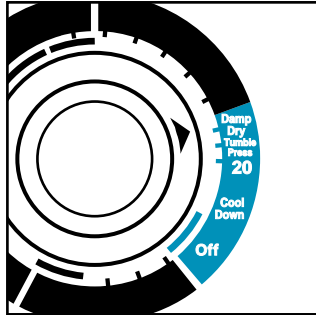

### FINISH GUARD® feature

(on some models)

When you are unable to remove a load from the dryer as soon as it stops, wrinkles can form. The FINISH GUARD feature periodically tumbles, rearranges, and fluffs the load to avoid wrinkles.

- If you do not open the dryer door within a few minutes after the cycle stops, the FINISH GUARD feature automatically takes over to protect the load.

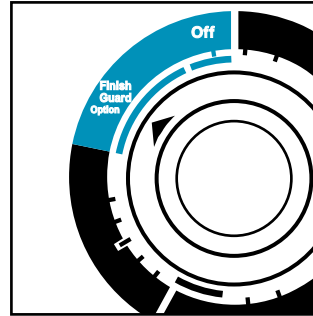

### Towels feature

(on some models)

When you have large loads of towels to dry, you may want to use the Towels feature in the Automatic cycle. The Towels setting allows for more drying time and automatically shuts off the dryer when the selected dryness is reached. The Towels feature also can be used for extra heavy items such as mattress pads and quilts. Set the Temperature selector to High heat.

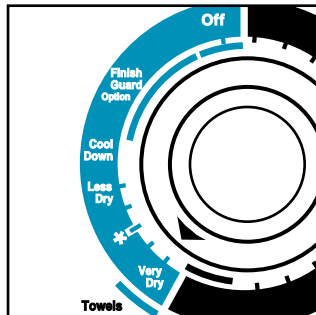

- On some models, you can turn the FINISH GUARD feature On or Off with a selector. (See Step 5 in “Starting Your Dryer.”)
- A signal will sound every few minutes while FINISH GUARD is running if the Cycle Signal (End of Cycle Signal) feature is set to On. On some models, this signal is fixed and cannot be turned off. The signal and cycle end when you open the dryer door.

### TUMBLE PRESS® feature

The TUMBLE PRESS feature in the Timed cycle removes wrinkles from clothes that have been packed in a suitcase or closet, or from items not removed from the dryer at the end of a cycle. As soon as the dryer stops, fold or put the items on hangers. Set the Temperature selector to Medium or Low heat.

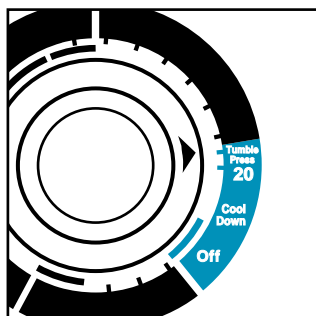



## USING THE DRYING RACK (AVAILABLE AS AN OPTION ON SOME MODELS)

To order a drying rack, call **1-800-253-1301**, from anywhere in the U.S.A. You will hear a recording. Follow the instructions to place an order.

The drying rack lets you dry items without tumbling them. The rack does not move, but the drum turns.

- 1.** Fit rear pegs of the rack into spaces in the back wall of the dryer. Lower the front so the legs rest on the dryer opening.

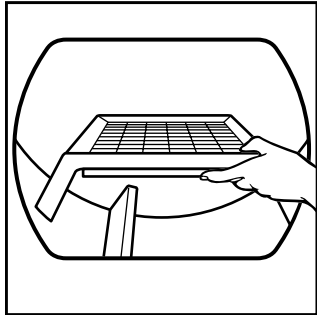

- 2.** Put wet items on top of the rack. Leave space between the items so air can reach all surfaces.

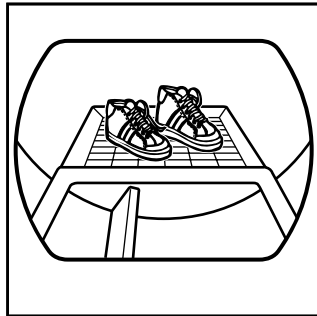

- See chart below for suggested cycles and settings for items that might best be rack dried. Drying time will depend on amount of moisture items hold.

**NOTE:** Make sure nothing hangs over the edge of the rack.

- 3.** Close the door.

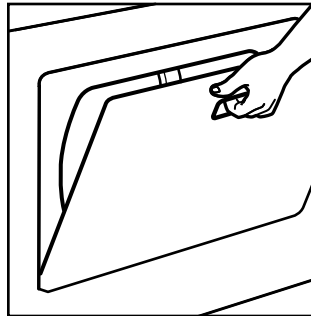

- 4.** Select the Timed drying cycle and temperature, or the Fluff Air cycle.

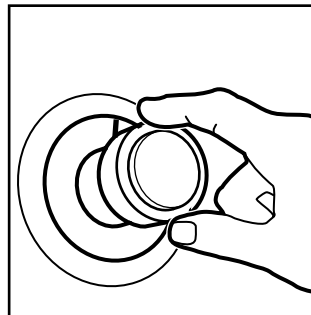

- 5.** Push the Start Button.

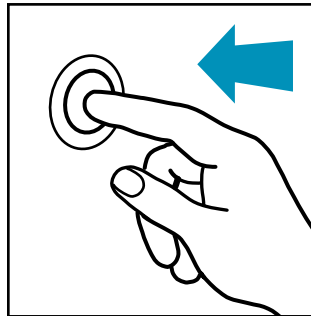

**NOTE:** The rack must be removed for normal tumbling. Automatic cycles do not work with the drying rack.

RACK DRY	CYCLE	TEMPERATURE	TIME* (minutes)
<b>Wool sweaters</b> (Block to shape and lay flat on the rack)	Timed drying	Low	60
<b>Stuffed toys or pillows</b> (Cotton or polyester fiber filled)	Timed drying	Low	60
<b>Stuffed toys or pillows</b> (Foam rubber filled)	Fluff Air	None; cycle is unheated.	90
<b>Sneakers or canvas shoes</b>	Fluff Air	None; cycle is unheated.	30-40

\*Reset cycle as needed to complete drying.

# CARING FOR YOUR DRYER

Proper care of your dryer can extend its life and help your dryer operate efficiently.

## USING AND MAINTAINING THE EASY CLEAN 100™ LINT FEATURE

Your dryer has the EASY CLEAN 100 lint collector basket. This new feature minimizes lint cleaning requirements. It is designed to reduce the need to clean the lint accumulation between each load, up to 100 loads, depending on the types of fabrics being dried. If you dry small loads or delicate fabrics more frequently, lint accumulation may take longer than with large loads or heavy fabrics.

### Emptying the lint collector basket

1. The collector basket is full when the lint reaches the shaded area within the window.

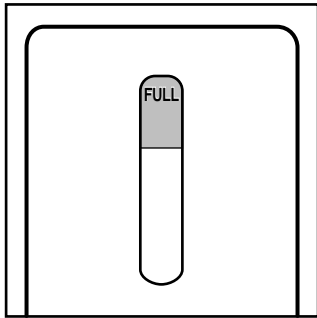

2. To open, lift the lid until it releases.

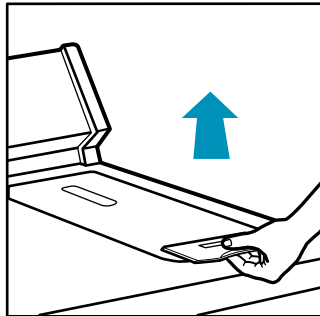

3. Hold lid open and pull the basket by its handle until it slides off the tracks.

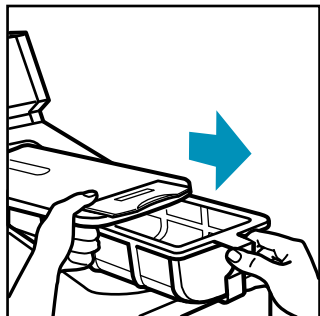

4. Turn basket upside down over a waste can and tap the basket lightly. Lint falls off easiest if basket is full. You may also see sand, grass, or other debris collected in basket.

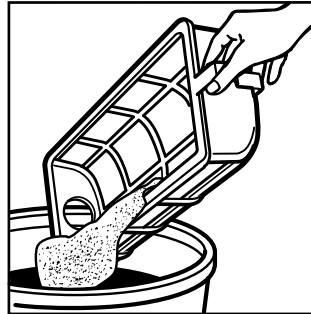

5. Reinsert the basket onto its tracks under the lid, and slide in until it stops.

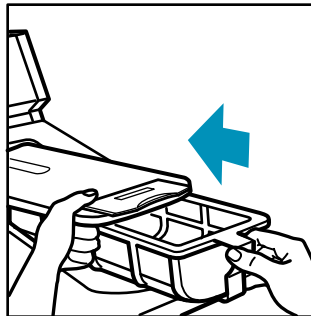

6. Lower lid until magnetic latch clicks.

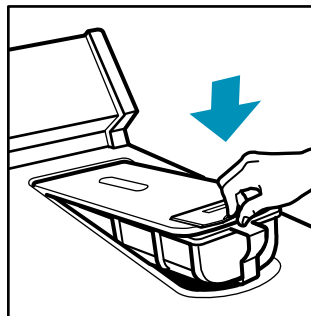

### NOTES:

- Do not run the dryer with the lint basket improperly inserted, damaged, blocked, or missing. Doing so can cause overheating and damage to both the dryer and fabrics.
- If there is no lint accumulation in the collector basket after several loads, contact our Consumer Assistance Center at **1-800-253-1301**.

## PERIODIC MAINTENANCE

You may find it necessary to clean the lint collector basket tray, and the transport tube opening, indicated by arrow.

1. Lift lid all the way and hold open.
2. Suction lint in tray and collector basket tray opening with vacuum cleaner.

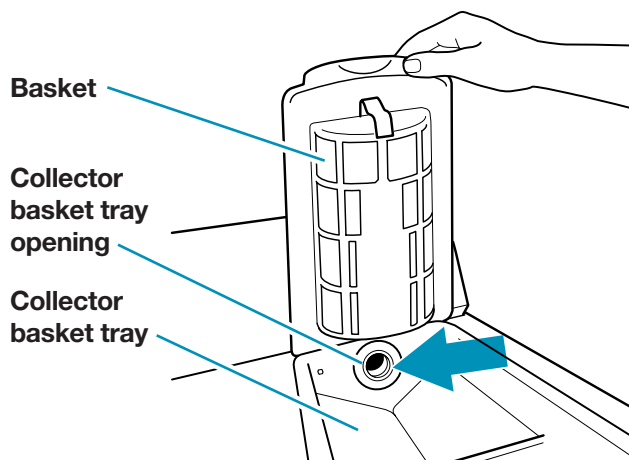

## CLEANING THE LINT COLLECTOR BASKET

Laundry detergents and fabric softeners can cause a residue buildup on the lint collector basket. Clean it with a nylon brush if it becomes clogged due to a residue buildup.

**Use the following method:**

1. Wet both sides of the lint collector basket with hot water.

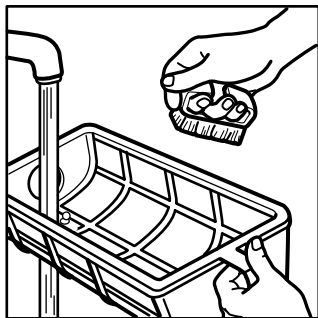

2. Wet a nylon brush with hot water and liquid detergent; brush lint collector basket gently to avoid damage while removing residue buildup.

3. Rinse lint collector basket with hot water.
4. **Thoroughly but gently** dry lint collector basket with a clean towel; replace in dryer.

## CLEANING THE DRYER INTERIOR

Garments which contain unstable dyes, such as denim blue jeans or brightly colored cotton items, may discolor the dryer interior. These stains are **not** harmful to your dryer and will not stain future loads of clothes. It is helpful to dry unstable dye items inside out to prevent dye transfer.

### To clean dryer drum:

1. Make a paste with powdered laundry detergent and very warm water.
2. Apply paste to a soft cloth.

### OR

Apply a liquid, non-flammable household cleaner to the stained area and rub with a soft cloth until all excess dye is removed.



3. Wipe drum thoroughly with a damp cloth.
4. Tumble a load of clean cloths or towels to dry drum.

## **!**WARNING



### Explosion Hazard

**Use nonflammable cleaner.**

**Failure to do so can result in death, explosion, or fire.**



## CHANGING THE DRUM LIGHT

The dryer light automatically turns on inside the dryer drum when you open the door. Your dryer's drum light may be one of two types, as shown.

### ! WARNING



#### Fire Hazard

Replace light bulb cover before operating dryer.

Failure to do so can result in death or fire.

### To change drum light type 1:

1. Unplug the dryer or disconnect the electricity leading to the dryer at the main power supply.

2. Open the dryer door. Remove the light bulb cover from the back wall of the dryer by turning the cover clockwise.

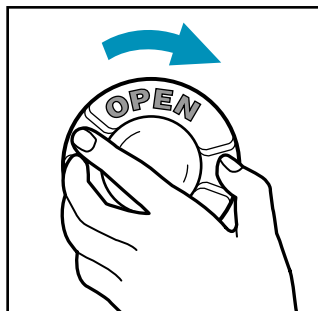

3. Remove the light bulb by turning it counterclockwise.
4. Replace the bulb with a 40-watt appliance bulb only.
5. Replace the light bulb cover and lock in place by turning counterclockwise.

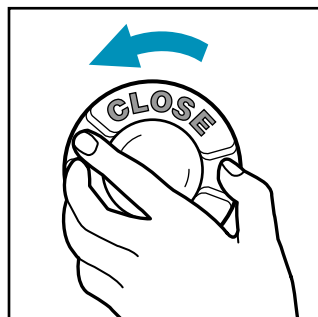

6. Reconnect power supply.

### To change drum light type 2:

1. Unplug the dryer or disconnect the electricity leading to the dryer at the main power supply.

2. Open the dryer door. Remove the light bulb cover from the back wall of the dryer by removing the screw located in the lower right corner of the cover.

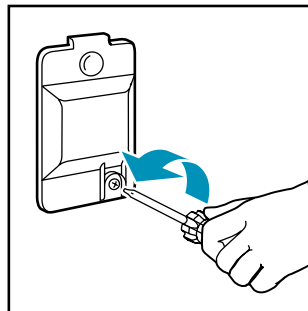

3. Remove the light bulb by turning it counterclockwise.
4. Replace the bulb with a 10-watt appliance bulb only.
5. Replace the light bulb cover.

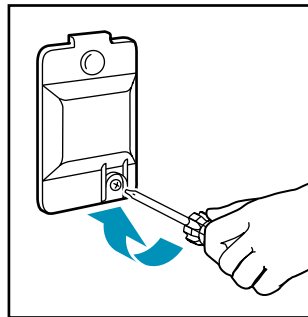

6. Reconnect power supply.

## REMOVING ACCUMULATED LINT FROM INSIDE THE DRYER CABINET

Lint can gather inside the dryer and be a fuel for fire. Lint should be removed every two to three years, or more often, depending on dryer usage. Cleaning should be done by a qualified person. If you have any questions or comments, please call our Consumer Assistance Center at **1-800-253-1301** from anywhere in the U.S.A.

1. Unplug dryer or turn off power supply.
2. Remove rear panel.
3. Remove any lint using a vacuum cleaner or soft brush. Avoid damaging wires and thermostats.
4. Replace rear panel.

5. Open top by pulling forward and up at each front corner (see illustration). Prop top at no more than a 90° angle.

**⚠ WARNING**



**Electrical Shock Hazard**  
Disconnect power before cleaning.  
Replace all panels before operating.  
Failure to do so can result in death or electrical shock.

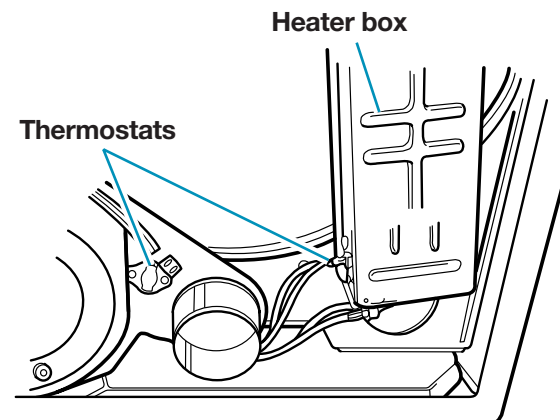

Dryer with rear panel removed

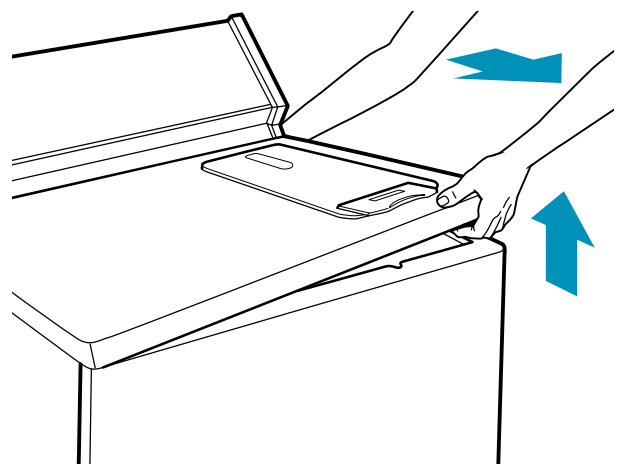

## REMOVING ACCUMULATED LINT FROM INSIDE THE DRYER CABINET (CONT.)

6. Remove 2 internal screws from front panel flanges (near top front corners). Lift front panel slightly, lifting off lower clips (see lower clip inset of illustration below). Slowly pull front panel forward, disengaging panel from drum. (Drum will drop slightly.)
7. Move front panel aside and rest edge against side of dryer. Avoid disconnecting wire clips (see wire clips inset of illustration below) or damaging wires.
8. Remove any lint using a vacuum cleaner or soft brush.

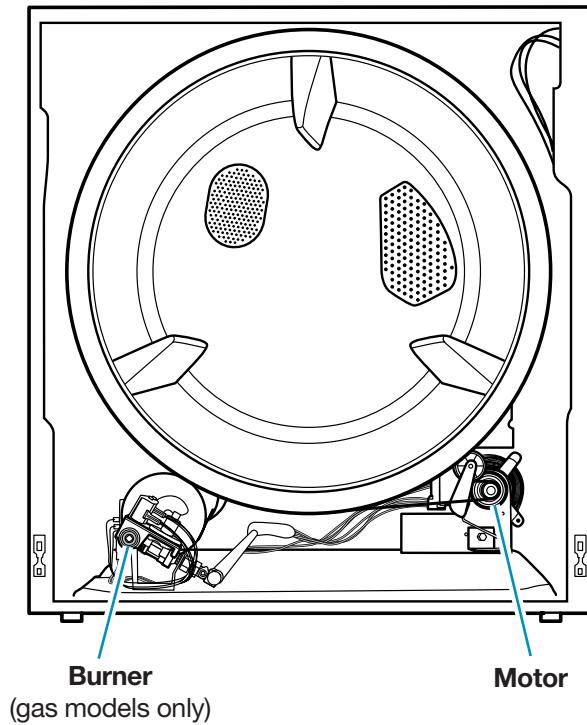

Dryer with front panel removed

9. Reassemble in reverse order. Before closing the top, check the following:
  - Drum seal must be flared out (see drum seal insets of illustration) and properly positioned against panel at back of drum. Rotate drum counterclockwise one full turn to check drum seal.
  - Belt should be centered and tight on dryer drum.
  - Wire clip retainer, which holds the door switch wires, must be secured to top of front panel (see wire clips inset of illustration) and along top edge of side panel. Door wires must not touch drum when dryer is operating.
10. Replace top panel. Top and front panels must be securely in place before operating dryer.
11. Level the dryer if necessary.
12. Plug in dryer or turn on power supply.

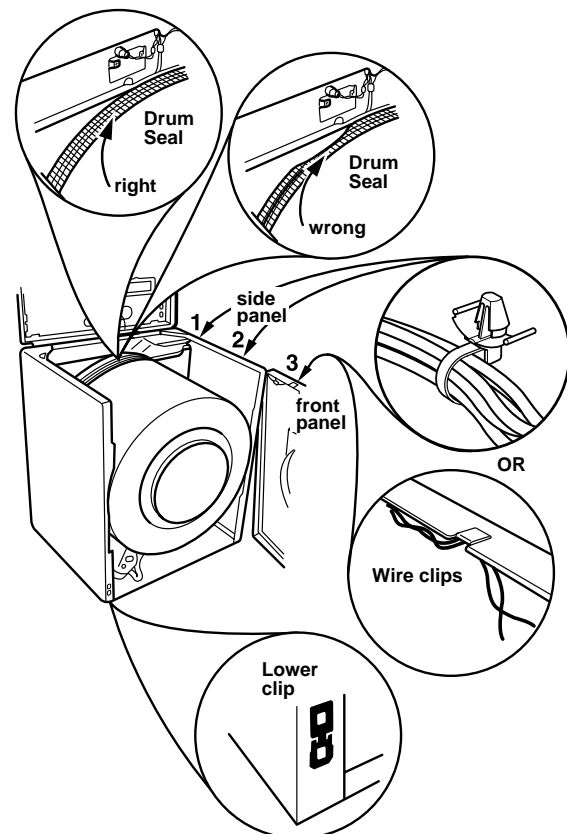

# TROUBLESHOOTING

Most laundering problems are easily solved if you understand the cause. Check the following list for **common laundry problems** and the next page for **common dryer problems**. If you need further assistance, see the “Requesting Assistance or Service” section.

**NOTE:** In the following list, the most common laundry problems are listed first.

## COMMON LAUNDRY PROBLEMS

Problem ...	Cause ...
Slow drying or clothes still wet	<ul style="list-style-type: none"><li>● Incorrect cycle or temperature setting selected.</li><li>● Full or clogged lint collector basket. (See the “Using and maintaining the EASY CLEAN 100™ lint feature” section.)</li><li>● Exhaust vent clogged, restricted, or too long. (See the “Venting” section and your Installation Instructions.)</li><li>● Dryer located in room with temperature below 45°F (7°C).</li><li>● Load too large and bulky to dry quickly.</li><li>● Drying heavy fabrics (denim, towels) with light fabrics (synthetics, permanent press).</li><li>● Fabric softener sheet blocking exhaust grill inside dryer drum.</li></ul>
Lint	<ul style="list-style-type: none"><li>● Full or clogged lint collector basket. (See the “Using and maintaining the EASY CLEAN 100 lint feature” section.)</li><li>● Load not properly sorted.</li><li>● Overdrying, especially synthetic fabrics that cause lint-attracting static electricity.</li><li>● Load size too big or heavy.</li><li>● Tissue or paper left in pockets.</li><li>● Pilling (surface fuzz caused by normal wear and laundering) attracts lint.</li></ul>
Static electricity	<ul style="list-style-type: none"><li>● Overdrying.</li><li>● Dryer fabric softener improperly used. See package directions.</li><li>● Load includes synthetics, synthetic blends, permanent press, and knit fabrics that build up static electricity.</li></ul>
Wrinkling	<ul style="list-style-type: none"><li>● Overloading.</li><li>● Overdrying, especially permanent press and synthetic fabrics.</li><li>● Large items balling or rolling up.</li><li>● Clothes left in dryer at end of cycle.</li></ul>
Shrinking	<ul style="list-style-type: none"><li>● Overdrying.</li><li>● Fabric or garment is not designed for tumble drying.</li><li>● Dryer settings incorrect for fabric type.</li><li>● Care label instructions not followed.</li></ul>
Greasy spots/stains	<ul style="list-style-type: none"><li>● Dryer fabric softener improperly used. Do not add to a warm load.</li><li>● Drying soiled items.</li></ul>
Color change	<ul style="list-style-type: none"><li>● Drying dark colors with light colors.</li><li>● Drying colorfast colors with non-colorfast colors.</li></ul>
Garment damage	<ul style="list-style-type: none"><li>● Zippers, snaps, and hooks left open.</li><li>● Strings and sashes not tied to prevent tangling.</li><li>● Care label instructions not followed.</li></ul>

## COMMON DRYER PROBLEMS

### 1. Dryer will not start.



Is the dryer door firmly closed?



Are the controls set in an ON position?



Did you firmly push the Start Button?



Is the power cord plugged in?

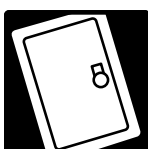

Have you blown a fuse or tripped a circuit breaker? Electric dryers use 2 household fuses or breakers.

### 2. Lint accumulation in hood or exhaust vent, or extended drying times.

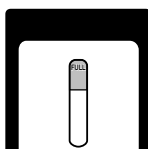

Is lint collector basket full?

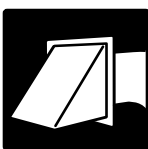

Is exhaust vent or outside exhaust hood clogged with lint? Refer to the "Venting" section.

### 3. No heat



For gas dryers, is the valve open on the supply line? Also, some dryers may have an internal gas valve. See Installations Instructions.

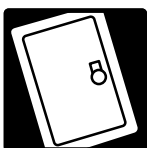

For electric dryers, have you blown a fuse or tripped a circuit breaker? Electric dryers use 2 household fuses or breakers. The drum may be turning but you may not have heat.

### 4. Noises



If the dryer hasn't been used for a while, there may be a thumping sound during the first few minutes of operation.

If noises continue, call the Consumer Assistance Center.

### 5. Odor



When operating a new dryer, the new electric heating element may have an odor.

Are household chemical odors being drawn into dryer? Proper ventilation must be used if painting or staining near the dryer.

**NOTE:** Store and use paints, varnishes, etc. away from your dryer whenever possible.

If you still have problems, see the "Requesting Assistance or Service" section.

# REQUESTING ASSISTANCE OR SERVICE

To avoid unnecessary service calls, please check the “Troubleshooting” section. It may save you the cost of a service call. If you still need help, follow the instructions below.

## IF YOU NEED ASSISTANCE OR SERVICE

**Call the Whirlpool Consumer Assistance Center toll free at 1-800-253-1301. Our consultants are available to assist you.**



When calling:

Please know the purchase date, and the complete model and serial number of your appliance (see the “A Note to You” section). This information will help us better respond to your request.

**Our consultants provide assistance with:**

- Features and specifications on our full line of appliances
- Installation information
- Use and maintenance procedures

- Accessory and repair parts sales
- Do-it-yourself repair help
- Specialized customer assistance (Spanish speaking, hearing impaired, limited vision, etc.)
- Referrals to local dealers, service companies, and repair parts distributors

**Whirlpool service technicians** are trained to fulfill the product warranty and provide after-warranty service, anywhere in the United States.

To locate the authorized Whirlpool service company in your area, you can also look in your telephone directory Yellow Pages.

## IF YOU NEED REPLACEMENT PARTS

If you need to order replacement parts, we recommend that you only use FSP® factory authorized parts. FSP replacement parts will fit right and work right, because they are made to the same exacting specifications used to build every new WHIRLPOOL® appliance.

To locate FSP replacement parts in your area, call our Consumer Assistance Center telephone number or your nearest authorized service center.

## FOR FURTHER ASSISTANCE

If you need further assistance, you can write to Whirlpool with any questions or concerns at:

Whirlpool Brand Home Appliances  
Consumer Assistance Center  
c/o Correspondence Dept.  
2000 North M-63  
Benton Harbor, MI 49022-2692

Please include a daytime phone number in your correspondence.

If the dealer, authorized servicer, and Whirlpool have failed to resolve your problem, you can contact the Major Appliance Consumer Action Program (MACAP). MACAP is a group of independent consumer experts that voice consumer views at the highest levels of the major appliance industry. MACAP will in turn inform us of your action.

Major Appliance Consumer Action Program  
20 North Wacker Drive  
Chicago, IL 60606

# INDEX

This index is alphabetical. Look for the word or phrase you are interested in, then look for the page number.

TOPIC	PAGE	TOPIC	PAGE
ASSISTANCE .....	22	FLUFF AIR .....	12
AUTOMATIC CYCLES .....	10	LINE DRYING .....	12
CARE/CLEANING		LINT	
Dryer interior .....	16	EASY CLEAN 100™ lint feature .....	14
EASY CLEAN 100™ lint feature .....	14	Removing lint inside dryer cabinet .....	18
LOADING .....	8-9	SELECTING CYCLE/SETTING .....	9-12
CYCLES .....	10-12	SERVICE .....	22
DRUM LIGHT .....	17	START BUTTON .....	9
DRYER		TEMPERATURE SELECTOR .....	8-11
Features .....	5	TIMED DRYING .....	10
Restarting .....	9	TOWELS .....	11
Safety .....	3-4	TROUBLESHOOTING	
Starting .....	8	Dryer problems .....	21
Stopping .....	9	Laundry problems .....	20
DRYING		TUMBLE PRESS® .....	11
Cycles .....	10-12	VENTING .....	6-7
Rack .....	13	WARRANTY .....	24
DRYING RACK .....	13		
END OF CYCLE SIGNAL .....	8		
FINISH GUARD® .....	8, 11		

# WARRANTY

## WHIRLPOOL® DRYER

LENGTH OF WARRANTY	WHIRLPOOL WILL PAY FOR																		
<b>FULL ONE-YEAR WARRANTY</b> FROM DATE OF PURCHASE	FSP® replacement parts and repair labor to correct defects in materials or workmanship. Service must be provided by an authorized Whirlpool service company.																		
<b>SECOND- THROUGH FIFTH-YEAR LIMITED WARRANTY</b> ON EASY CLEAN 100™ lint feature parts only FROM DATE OF PURCHASE	FSP® replacement parts to correct defects in materials or workmanship of the following parts: <table style="width: 100%; border-collapse: collapse;"> <thead> <tr> <th style="text-align: left; width: 60%;">Part</th> <th style="text-align: left;">Part No.</th> </tr> </thead> <tbody> <tr> <td>Collector assembly</td> <td>3404418 (white), 3404419 (almond)</td> </tr> <tr> <td>Hinge</td> <td>3402247</td> </tr> <tr> <td>Seal - lid</td> <td>3402261</td> </tr> <tr> <td>Seal - basket</td> <td>3402260</td> </tr> <tr> <td>Transport tube assembly</td> <td>3405475</td> </tr> <tr> <td>Recirculate tube</td> <td>3399992</td> </tr> <tr> <td>Tray assembly</td> <td>3402306</td> </tr> <tr> <td>Latch assembly</td> <td>3404451 (white), 3404452 (almond)</td> </tr> </tbody> </table>	Part	Part No.	Collector assembly	3404418 (white), 3404419 (almond)	Hinge	3402247	Seal - lid	3402261	Seal - basket	3402260	Transport tube assembly	3405475	Recirculate tube	3399992	Tray assembly	3402306	Latch assembly	3404451 (white), 3404452 (almond)
Part	Part No.																		
Collector assembly	3404418 (white), 3404419 (almond)																		
Hinge	3402247																		
Seal - lid	3402261																		
Seal - basket	3402260																		
Transport tube assembly	3405475																		
Recirculate tube	3399992																		
Tray assembly	3402306																		
Latch assembly	3404451 (white), 3404452 (almond)																		
<b>WHIRLPOOL WILL NOT PAY FOR</b>																			
<p><b>A.</b> Service calls to:</p> <ol style="list-style-type: none"> <li>1. Correct the installation of your dryer, including venting. Heavy four-inch metal exhaust vent must be used. Refer to the venting section of this manual and your Installation Instructions.</li> <li>2. Instruct you how to use your dryer.</li> <li>3. Replace house fuses or correct house wiring or plumbing.</li> <li>4. Replace light bulbs.</li> </ol> <p><b>B.</b> Repairs when your dryer is used in other than normal, single-family household use.</p> <p><b>C.</b> Pickup and delivery. Your dryer is designed to be repaired in the home.</p> <p><b>D.</b> Damage to your dryer caused by accident, misuse, abuse, improper installation (including, but not limited to, venting with plastic or flexible foil), installation not in accordance with local electrical or plumbing codes, use of products not approved by Whirlpool, or acts of God.</p> <p><b>E.</b> Repairs to parts or systems caused by unauthorized modifications made to the appliance.</p>																			

11/96

**WHIRLPOOL CORPORATION SHALL NOT BE LIABLE FOR INCIDENTAL OR CONSEQUENTIAL DAMAGES.**

Some states do not allow the exclusion or limitation of incidental or consequential damages, so this exclusion or limitation may not apply to you. This warranty gives you specific legal rights, and you may also have other rights which vary from state to state.

**Outside the United States, a different warranty may also apply. For details, please contact your authorized Whirlpool dealer.**

If you need service, first see the "Troubleshooting" section of this book. After checking "Troubleshooting," additional help is available by checking the "Requesting Assistance or Service" section, or by calling our Consumer Assistance Center telephone number, **1-800-253-1301**, from anywhere in the U.S.A.

**PART NO. 3406072**

**CARD NO. 2193047**

© 1996 Whirlpool Corporation

© Registered Trademark/TM Trademark of Whirlpool, U.S.A.

11/96  
Printed in U.S.A.